

IE5362

IEB3004-BPKG/V4/AS-514-TPS RT

Inductive sensors

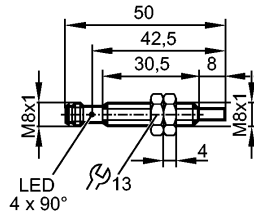

Product characteristics

Inductive sensor
Metal thread M8 x 1
Connector
oil-resistant potting
Sensing range 4 mm; [nf] non-flush mountable

Electrical data

Electrical design	DC PNP
Operating voltage [V]	10...36 DC; to PELV
Current consumption [mA]	< 15
Protection class	III
Reverse polarity protection	yes

Outputs

Output function	normally open
Voltage drop [V]	< 2.5
Current rating [mA]	250
Short-circuit protection	pulsed
Overload protection	yes
Switching frequency [Hz]	300

Range

Sensing range [mm]	4
Operating distance [mm]	0...3.25

Accuracy / deviations

Correction factors	mild steel = 1 / stainless steel approx. 0.7 / brass approx. 0.5 / Al approx. 0.4 / Cu approx. 0.3
Hysteresis [% of Sr]	1...20

Environment

Ambient temperature [°C]	-10...70
Protection	IP 67; if screwed on

Tests / approvals

EMC	EN 61000-4-2 ESD: 4 kV CD / 8 kV AD EN 61000-4-3 HF radiated: 10 V/m EN 61000-4-4 Burst: 2 kV EN 61000-4-5 Surge: 0.5 kV (line to line, Ri: 20hm) EN 61000-4-6 HF conducted: 10 V EN 55011: class B
-----	--

MTTF [Years]	2359
--------------	------

Mechanical data

Mounting	non-flush mountable
----------	---------------------

IE5362

IEB3004-BPKG/V4/AS-514-TPS RT

Inductive sensors

Housing materials	stainless steel 316Ti / 1.4571; LCP
-------------------	-------------------------------------

Weight [kg]	0.019
-------------	-------

Displays / operating elements

Output status indication	LED	red (4 x 90°)
--------------------------	-----	---------------

Electrical connection

Connection	M8 connector
------------	--------------

Wiring

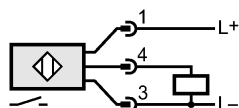
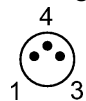

Accessories

Accessories (included)	2 lock nuts
------------------------	-------------

Remarks

Pack quantity [piece]	1
-----------------------	---